

INSTALLATION INSTRUCTIONS

LAGUNA REAR PARTITION

APPLICATION: 2021 Chevrolet Tahoe PPV

PART NUMBER: CT6500 Series

CONTENT			
ITEM	QUANTITY	DESCRIPTION	TOOLS NEEDED
1	1	SCREEN	18MM SOCKET
2	1	FILLER PANEL	15MM SOCKET
3	1	FILLER PANEL DOOR	13MM SOCKET
4	1	DRIVER STRAP	5MM ALLEN
5	1	PASSENGER STRAP	RATCHET
6	1	DRIVER MOUNING BRACKET	TORQUE WRENCH
7	1	PASSENGER MOUNTING BRACKET	TRIM TOOL
8	1	DRIVER UPRIGHT	
9	1	PASSENGER UPRIGHT	
10	1	CROSS FRAME	
11	1	BELT SUPPORT BRACKET	
12	26	M8 HEX HEAD BOLT SHORT	
13	4	M8 HEX HEAD BOLT LONG	
14	2	M8 BUTTON HEAD BOLT	
15	4	M8 FLANGE HEX HEAD NUT	
16	32	M8 FLAT WASHER	
17	28	M8 LOCK WASHER	
18	2	M10 FLANGE BOLT	
19	2	M12 FLANGE BOLT	
ANTI-SEIZE LUBRICANT MUST BE USED ON ALL STAINLESS STEEL FASTENERS TO PREVENT THREAD DAMAGE AND GALLING			

PROCEDURE

1. Remove contents from box, verify if all parts listed are present and free from damage.
Carefully read and understand all instructions before attempting installation.
Failure to identify damage before installation could lead to a rejection of any claim.



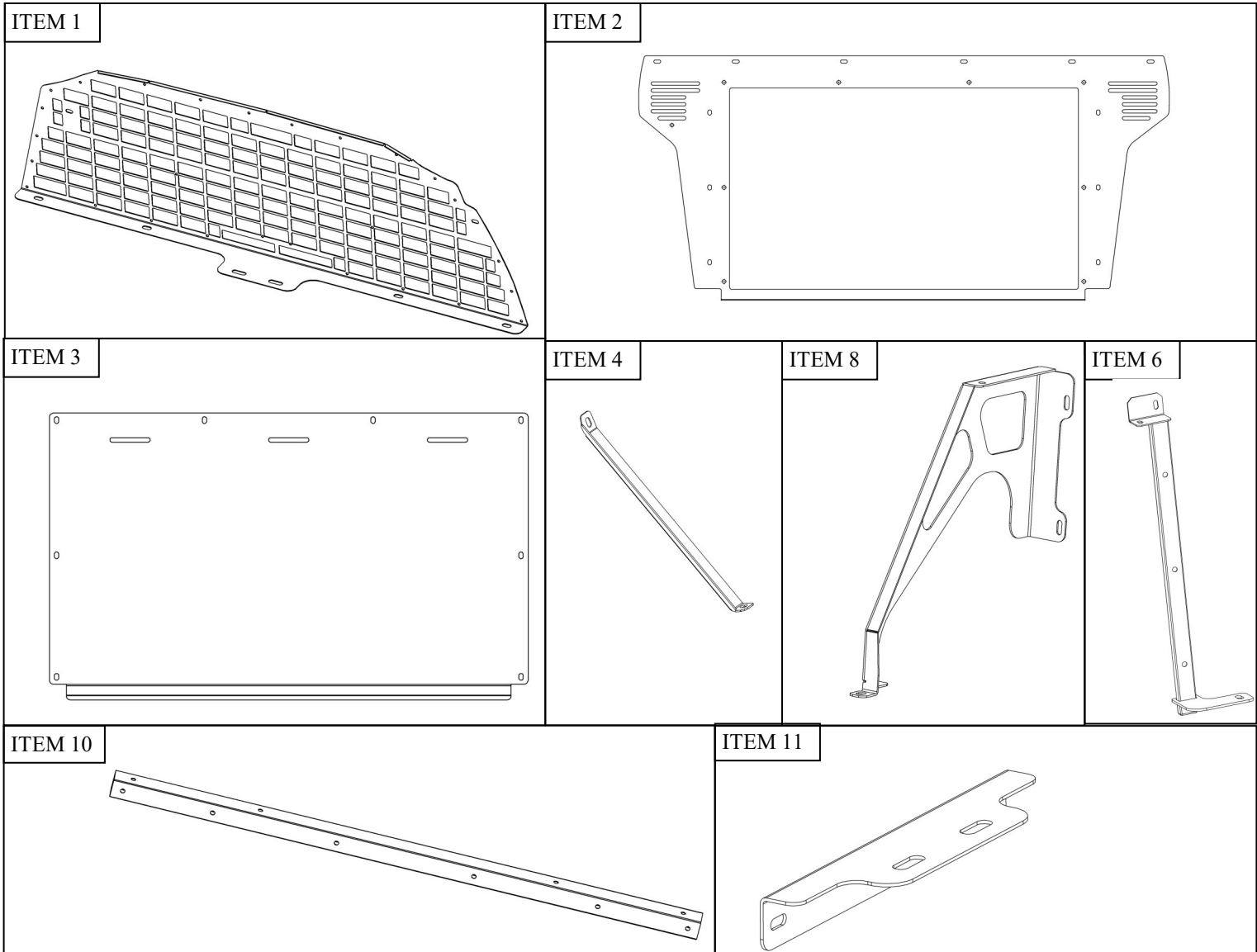

2. Roll and flip the rear seats toward the front of the vehicle for easy access. See Figure 1



3. Locate the two rear holes on the floor for the upright brackets. Cut away enough rubber flooring just to access the holes. The front-most holes are 36.4 inches apart. The rear-most holes are 48 inches apart. *Note: if there are studs near the mounting holes, cut them off. See Figure 2-3*

Figure 2

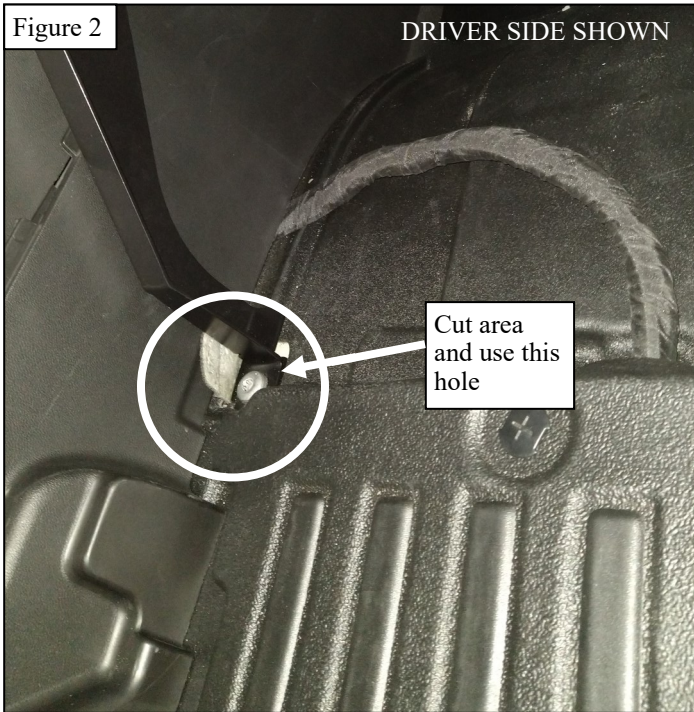
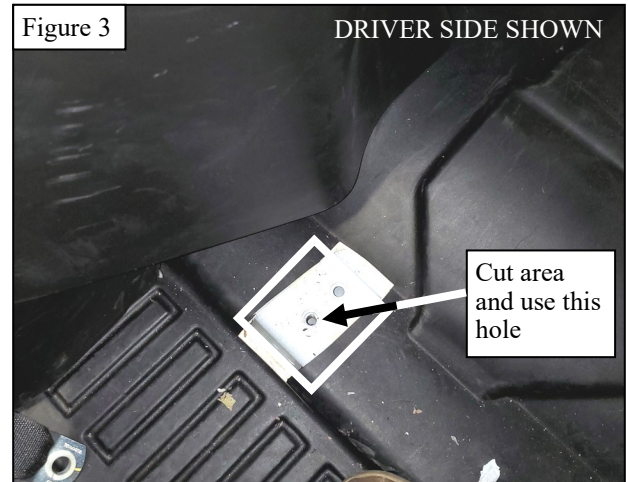

Figure 3



4. Locate the driver and passenger main mounting brackets (6,7). Loosely install the main brackets in the front holes you located using supplied M10 hardware. **See Figures 3 & 4.**
5. Assemble the cross frame to the mounting brackets using supplied M8 hardware 12 (short bolt) 16 & 17. **See Figure 5**

Figure 4

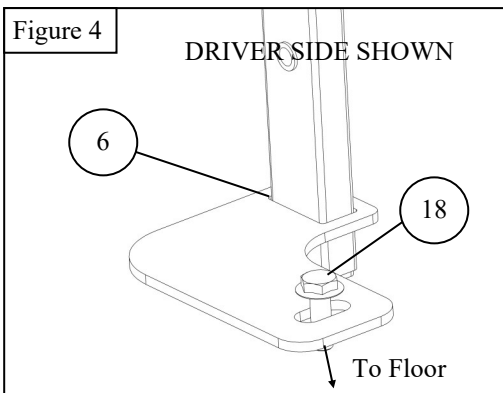
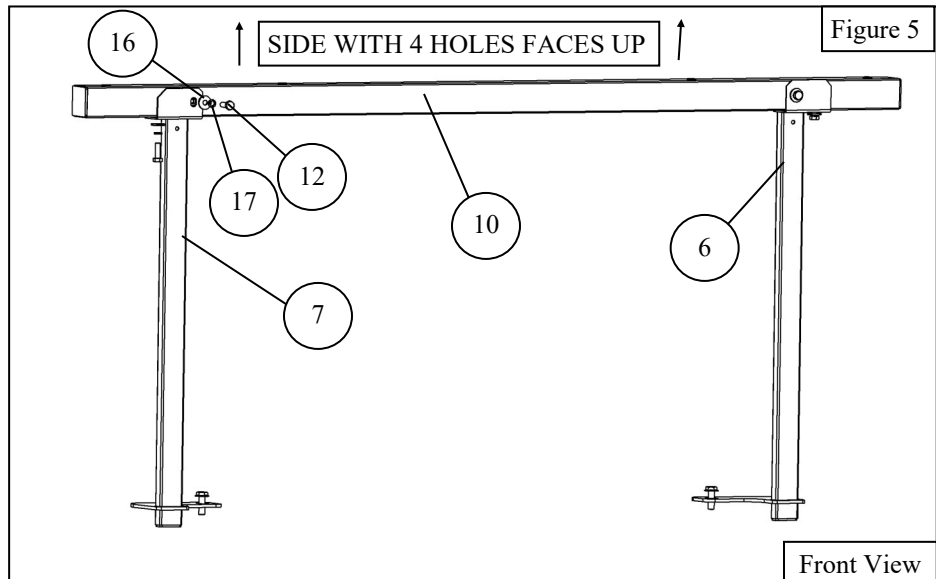
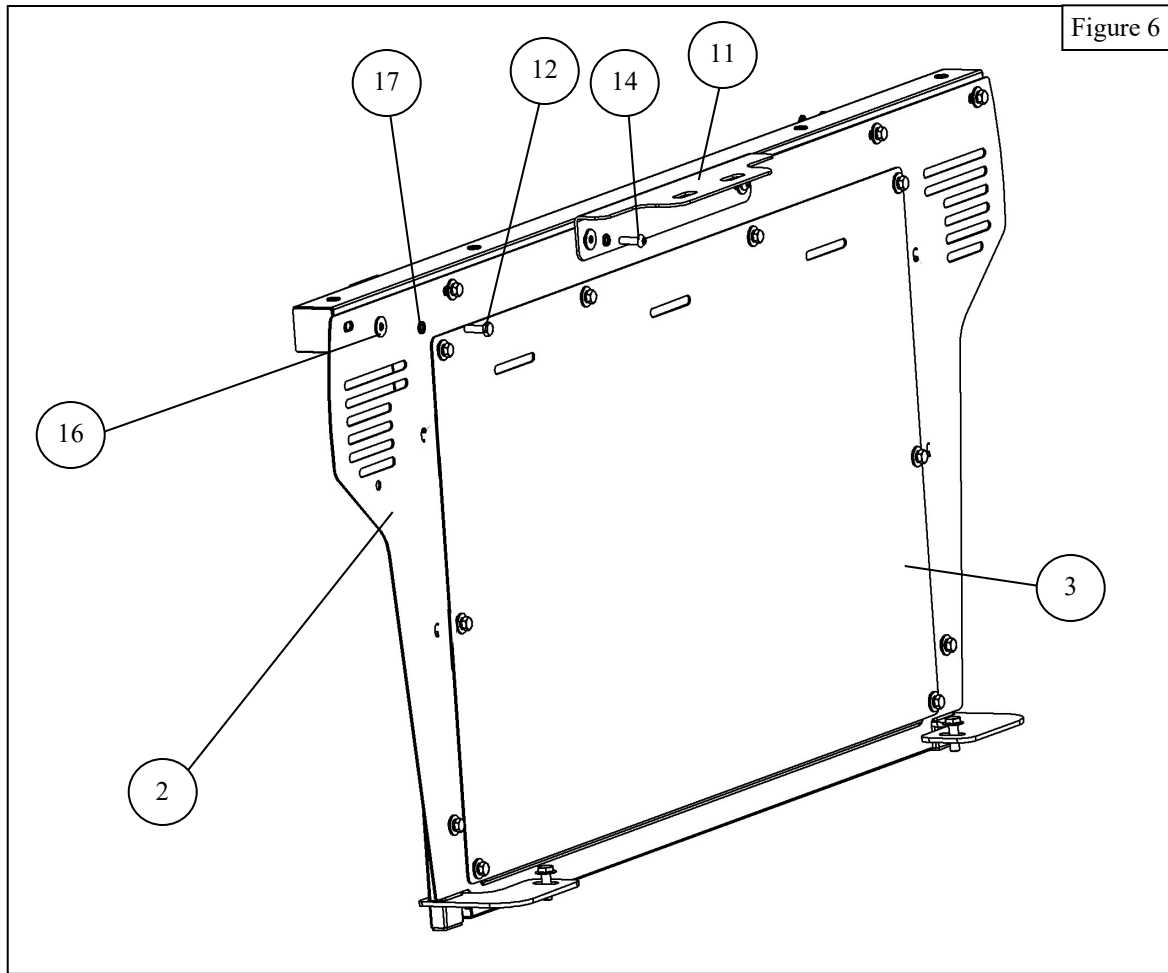

Figure 5



6. Using supplied M8 hardware 12 (short bolt) 16 & 17, loosely assemble the filler panel. After, loosely install the filler panel door. See Figure 6



7. Locate the driver/passenger uprights (8,9). Using supplied M8 hardware 12 (short bolt) 16 & 17, Assemble the uprights to the outer filler panel. See Figure 7 & 8. and use the M12 Flange bolt (19) to install the upright in the vehicle's floor.

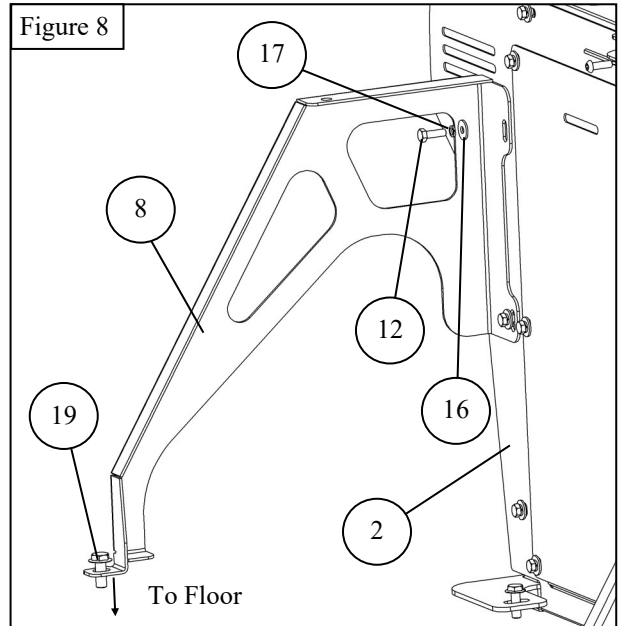

8. If you are installing the optional prisoner seat (35-14065), do so at this time. The prisoner seat will mount in between the cross frame and upper screen. **See Figure 9**
9. Locate the Screen (1) and driver/passenger straps (4,5). Using supplied M8 hardware 13 (long bolt) 16 & 17, loosely assemble the screen to the cross frame. Mount the straps to the uprights and screen using M8 Hardware 14, 16 & 15 at the top holes in the screen (1) (Item 14, bolt's round head must be facing the vehicle's front) and M8 Hardware 12 (short bolt), 16 & 15 on to the uprights holes (8, 9) **See Figure 9**

Figure 9

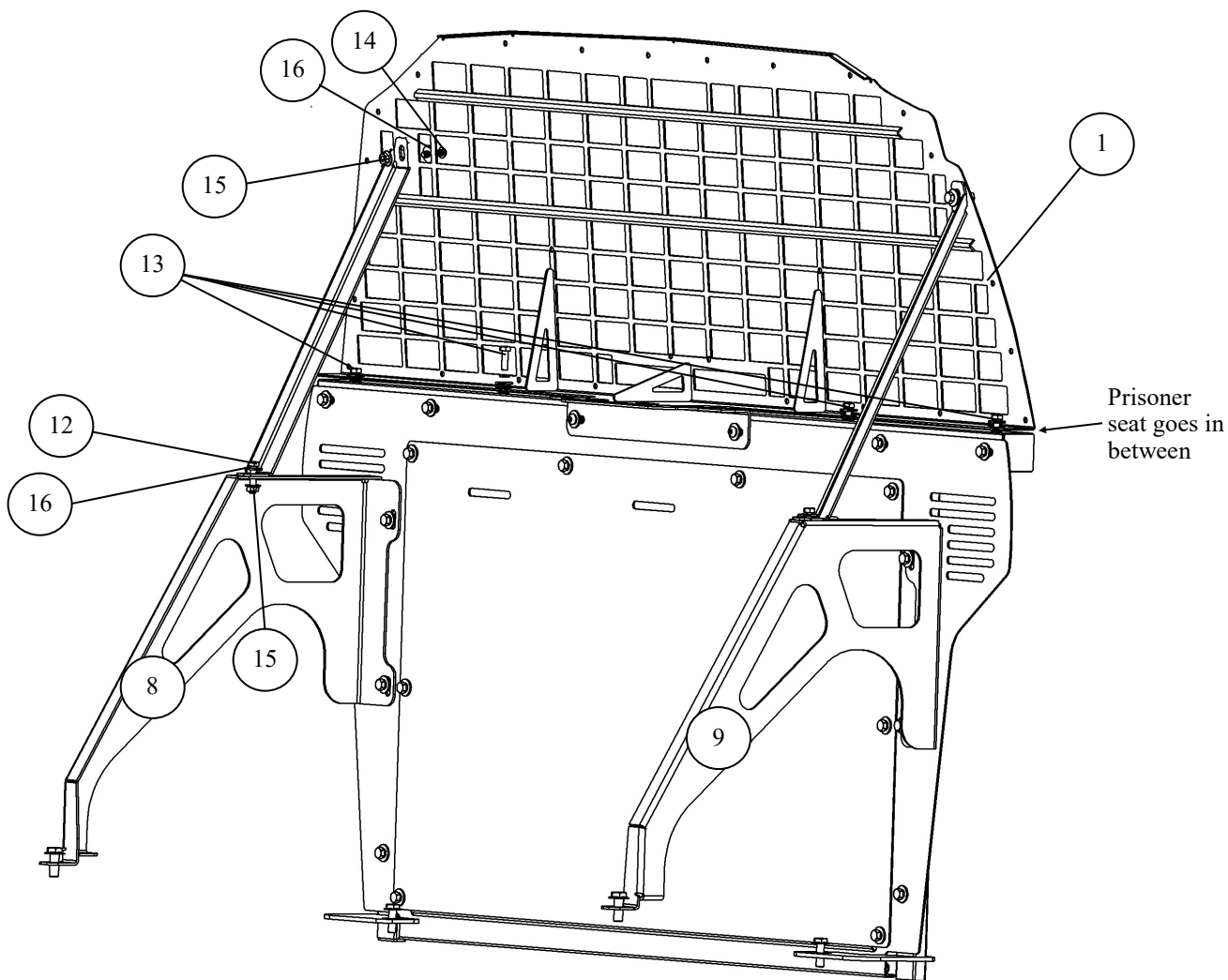

10. Adjust as needed and torque as specified: M8 to 15-18 ft. lbs., M10 to 35-38 ft lbs., M12 to 50 ft. lbs.

INSTALLATION COMPLETE



CARE INSTRUCTIONS

- REGULAR WAXING IS RECOMMENDED. DO NOT USE ANY TYPE OF POLISH OR WAX THAT MAY CONTAIN ABRASIVES.
- STAINLESS STEEL PRODUCTS CAN BE CLEANED WITH MILD SOAP AND WATER. STAINLESS STEEL POLISH SHOULD BE USED TO POLISH SMALL SCRATCHES.
- GLOSS BLACK FINISHES SHOULD BE CLEANED WITH MILD SOAP AND WATER.

LAGUNA
MANUFACTURING



INSTALLATION INSTRUCTIONS

Laguna Prisoner Seat with Ready Buckle

APPLICATION: 2021 Chevrolet Tahoe PPV

PART NUMBER: CT6500 Series

CONTENT			
ITEM	QUANTITY	DESCRIPTION	TOOLS NEEDED
1	1	PRISONER SEAT	17MM SOCKET
2	2	RETRACTOR	3/4" SOCKET
3	2	M12 HEX HEAD BOLT	RATCHET
4	2	M12 NYLOCK NUT	TORQUE WRENCH
5	2	1/2" USS FLAT WASHER	
6	2	BUCKLE LOCK	
7	4	#14 x 1.5 SELF TAPPING SCREWS	
8	2	STORAGE BUCKLE LATCH	
9	2	1/4" BUTTON HEAD BOLT	
10	4	1/4" USS FLAT WASHER	
11	2	1/4" NYLOCK NUT	
12	2	CENTER SEAT BELT HOLES—PLASTIC COVERS	
13	12	#6x3/8" ROUNDED SELF TAPPING SCREWS	
ANTI-SEIZE LUBRICANT MUST BE USED ON ALL STAINLESS STEEL FASTENERS TO PREVENT THREAD DAMAGE AND GALLING			

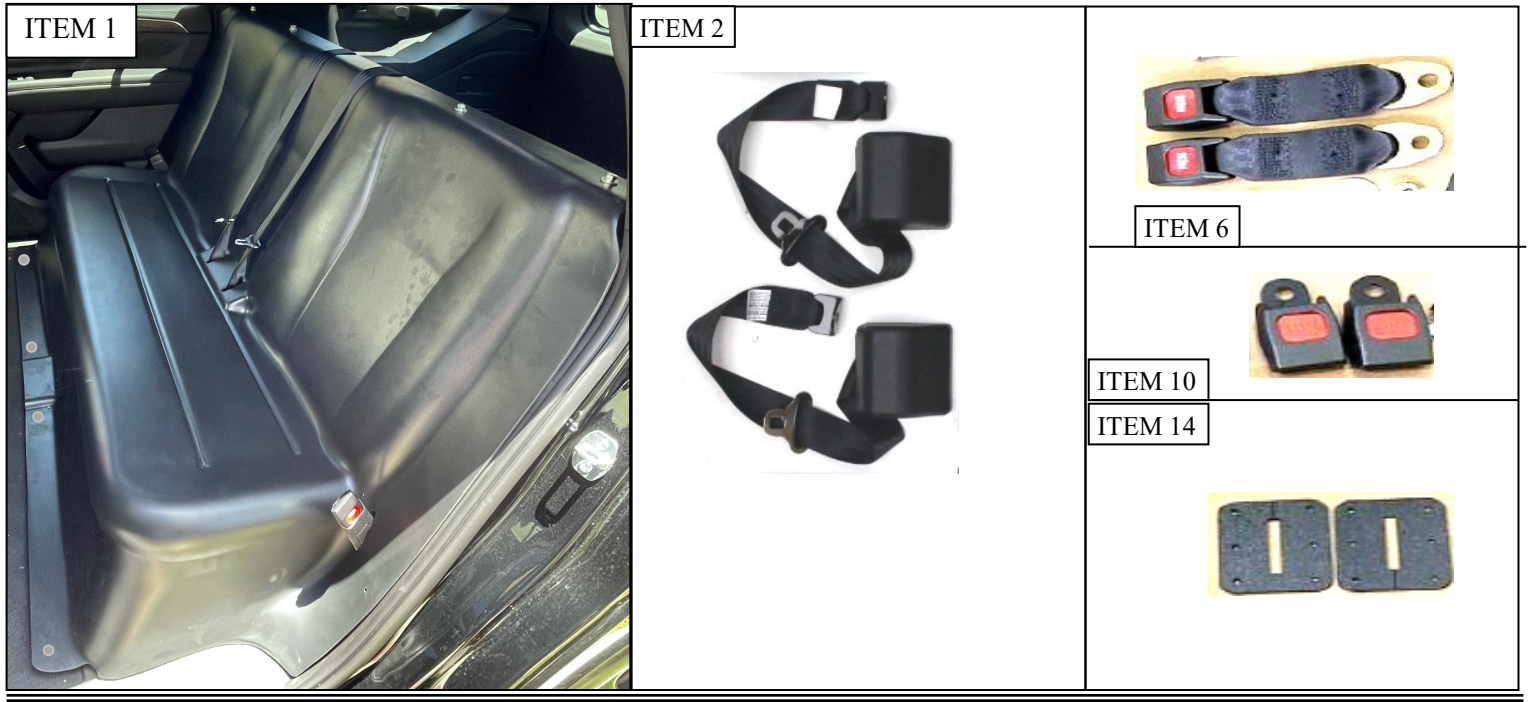

PROCEDURE

1. Remove contents from box, verify if all parts listed are present and free from damage.
Carefully read and understand all instructions before attempting installation.
Failure to identify damage before installation could lead to a rejection of any claim.

2. Remove the factory rear seats and passenger/driver side kick panels. **See Figure 1-3**

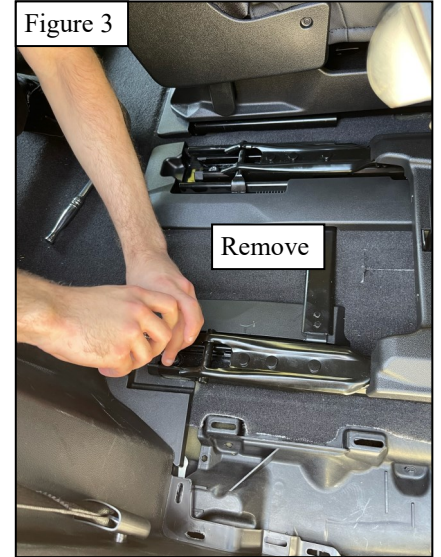

3. Locate the prisoner seat and with help, align in the area in front of the rear partition already installed. **See Figure 4.**
Note: Refer to the rear partition installation sheet for hardware (torque) instructions.

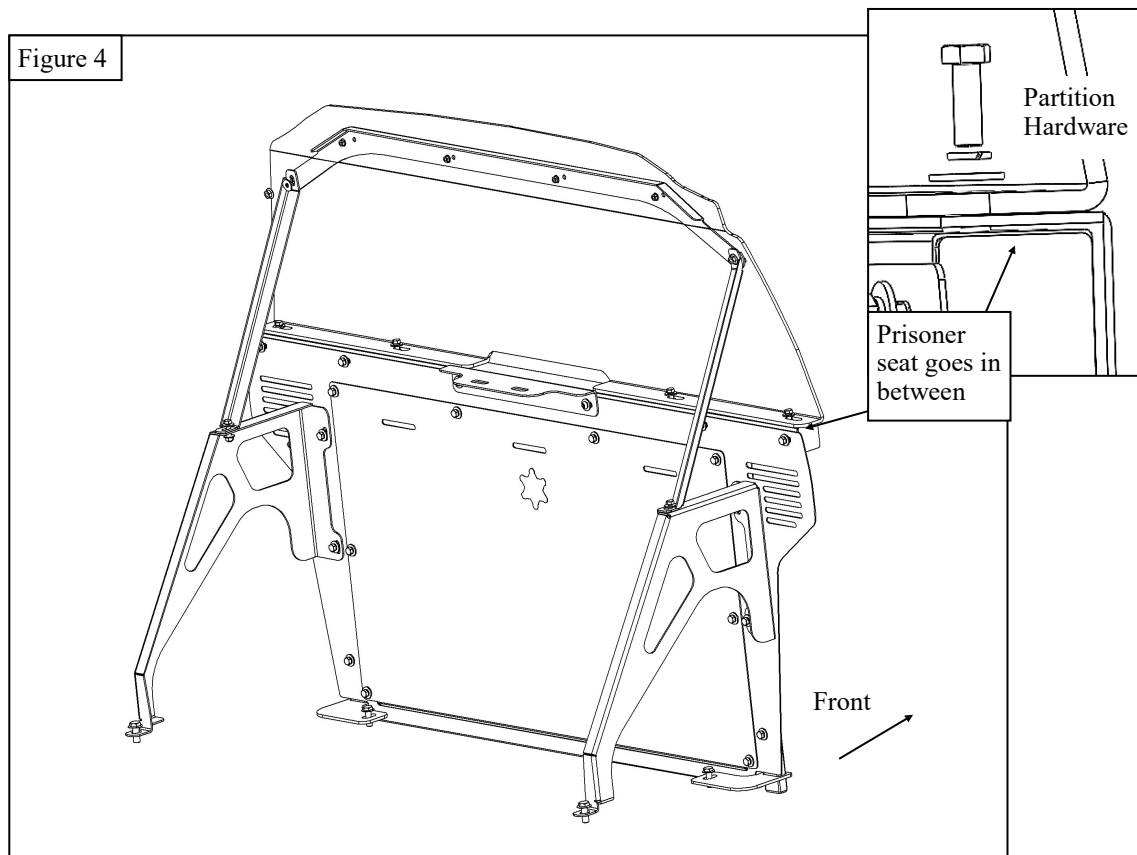

4. Locate the retractors. Remove the plastic cover from the retractors and using supplied M12 hardware, assemble the retractors to the rear partition. Leave hardware slightly loose so that retractors can slightly move for adjustability. See Figures 5-8

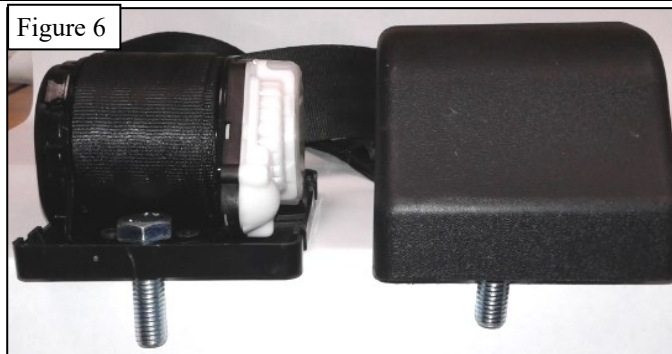
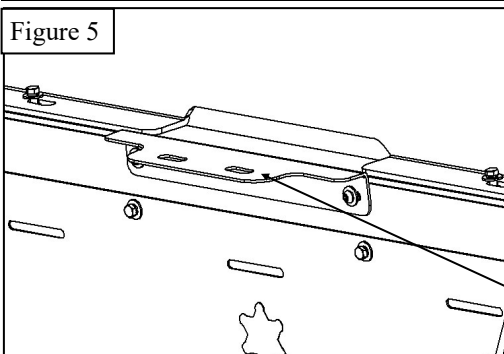

Install retractors here



5. Slide the belt through the seat slots in the middle as shown in **Figure 7-9**.
6. Using the factory seat hardware, assemble the belt straps to the floor as shown in **Figures 10 & 11**.
7. Using the pre-drilled holes in the front of the seat, install the supplied #4 self tapping screws (7) into the sea and vehicle floor. See **Figure 9**.

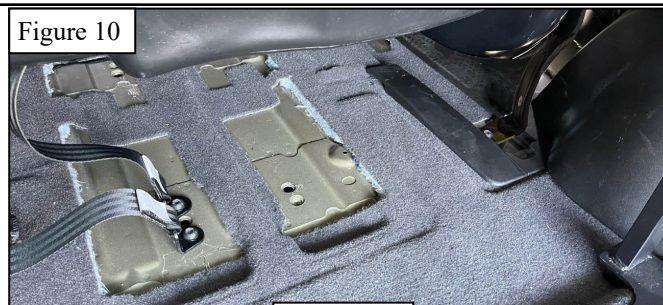
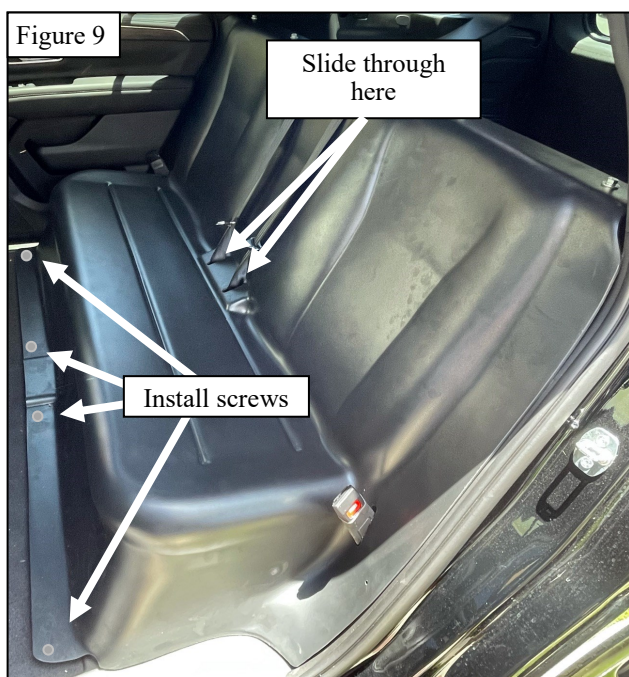

8. Slide the buckle locks through the slot in the seat. Using factory hardware, assemble the buckle locks (6) to the floor. See **Figure 12**.
9. Locate the storage belt buckle latch. Assemble to the front partition as shown in **Figure 13**.
10. Install the seat belt plastic covers with supplied #6 x 3/8" self tapping rounded screws as shown in **Figure 14**.
11. Replace the kick panels previously removed.
12. Tighten all hardware. Torque 1/4" to 8 Ft Lb, 3/8" to 30 Ft Lb, M12 to 65 Ft Lb. 1/2 to 75 Ft Lb. M8 to 27 Ft Lb.

Figure 12

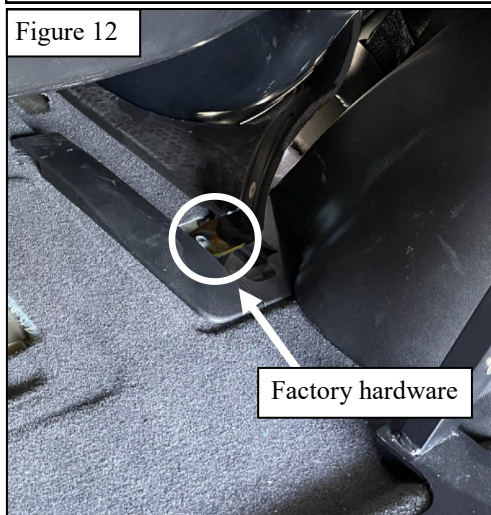

Figure 13



Figure 14

INSTALLATION COMPLETE



CARE INSTRUCTIONS

- REGULAR WAXING IS RECOMMENDED. DO NOT USE ANY TYPE OF POLISH OR WAX THAT MAY CONTAIN ABRASIVES.
- STAINLESS STEEL PRODUCTS CAN BE CLEANED WITH MILD SOAP AND WATER. STAINLESS STEEL POLISH SHOULD BE USED TO POLISH SMALL SCRATCHES.
- GLOSS BLACK FINISHES SHOULD BE CLEANED WITH MILD SOAP AND WATER.



WARNING



Failure to follow these instructions could lead to death, personal injury, and / or property damage.

Failure to follow these instructions could lead to death, personal injury, and / or property damage.

FASTENERS:

All Laguna supplied fasteners must be utilized and installed in accordance with the installation instructions and apply torque to the specifications as defined. **DOUBLE CHECK ALL FASTENERS BEFORE INITIAL USE, AND PERIODICALLY IN THE FUTURE TO ENSURE PROPER FUNCTION AND SAFETY.**

DRILLING:

Most Laguna products do not require drilling for installation. If drilling is defined as required, use caution when drilling a vehicle. **FAILURE TO REVIEW AN AREA TO BE DRILLED MAY RESULT IN PERSONAL INJURY AND/OR INJURY TO OTHERS AS WELL AS VEHICLE DAMAGE.**

EYE PROTECTION:

ALWAYS WEAR SAFETY GLASSES OR GOGGLES DURING THE INSTALLATION PROCESS TO AVOID PERSONAL INJURY.

FOR CALIFORNIA RESIDENTS ONLY-PROP 65 WARNING:

Some products may contain chemicals such as DEHP, which can cause cancer, birth defects or other reproductive harm. For more info go to www.p65warnings.ca.gov