



INSTALLATION INSTRUCTIONS

2020+ POLICE INTERCEPTOR UTILITY

**We recommend to read through
installation guide before start of install**

ITEM	QUANTITY	DESCRIPTION	TOOLS NEEDED
1	1	REAR GUARD ASSEMBLY SCREEN	13MM SOCKET
2	1	FILLER PANEL	15MM SOCKET
3	1	FRAME	13MM WRENCH
4,5	2	SUPPORT BRACKET, DRIVER (4) AND PASSENGER (5)	4MM ALLEN WRENCH
6, 7	2	SUPPORT STRAP DRIVER (6) AND PASSENGER (7)	5MM ALLEN WRENCH
8, 9	2	INNER SUPPORT BRACKET DRIVER (8) AND PASSENGER (9)	DRILL BIT
10	1	SEAT BELTS SUPPORT BRACKET	MOTOR DRILL
11	22	M8 HEX HEAD CAP SCREW (BLACK ZINC)	CUTTING TOOL
12	22	M8 FLAT WASHER (BLACK ZINC)	SOCKET EXT.
13	22	M8 SPLIT LOCK WASHER (BLACK ZINC)	RATCHET
14	4	M8 RIV-NUT	TORQUE WRENCH
15	4	M8 FLANGE NUT	
16	4	M6 BUTTON HEAD CAP SCREW (BLACK ZINC)	
17	4	M6 FLAT WASHER (BLACK ZINC)	
18	4	M6 LOCKWASHER (BLACK ZINC)	
19	4	M6 U-CLIP (BLACK ZINC)	
20	4	M10 FLANGE BOLT 1.5x50mm	
21	1	RIV-NUT INSTALL TOOL	
22	1	M8 HEX HEAD BOLT—FOR RIV-NUT INSTALLATION	
23	1	START WASHER —FOR RIV-NUT INSTALLATION	

ANTI-SEIZE LUBRICANT MUST BE USED ON ALL STAINLESS STEEL FASTENERS TO PREVENT THREAD DAMAGE AND GALLING

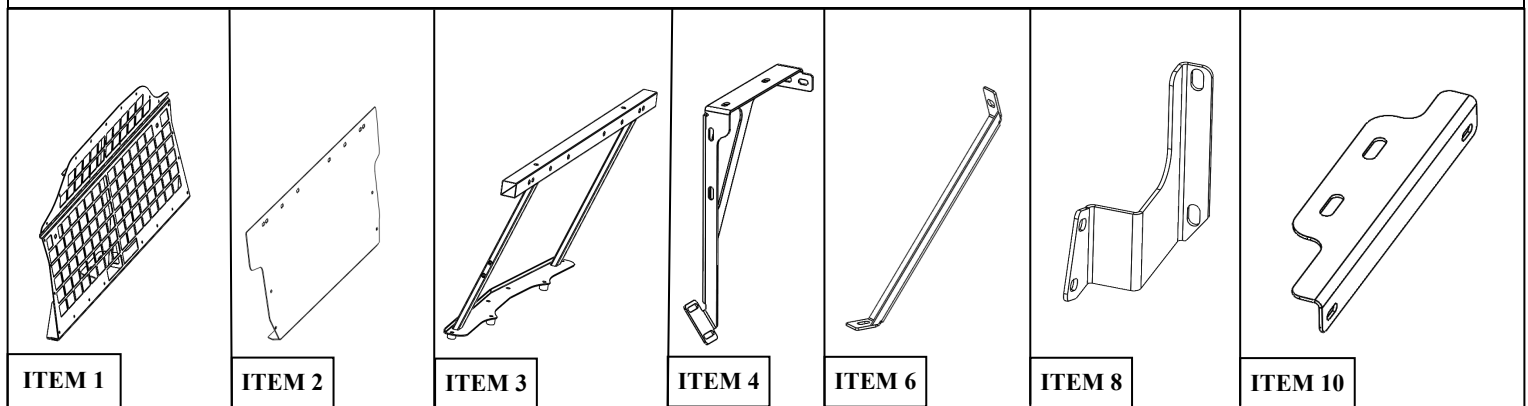

PROCEDURE

1. Remove contents from pallet. verify if all parts listed are present and free from damage. Carefully read and understand all instructions before attempting installation.
Failure to identify damage before installation could lead to a rejection of any claim.



2. Remove floor covers in the cargo area.
3. Remove the screws that holds the foam blocks. Save them for re-installation (Figure 1) and remove the far rear foam blocks. Save them they will be placed back later.
4. Remove the plastic plugs that hold the plate and the electronic connections to the foam block and pull up the foam block from the back. Then remove the block. (Figures 2 & 3)
5. Trim the foam block 3 3/4" as shown in Figure 4.
6. If installing the rear partition with the factory seats, remove the 6 bolts behind the rear seats. Figure 5.
7. If installing with our prisoner seat, remove the 12 bolts that hold the seats, disconnect sensors and carefully remove all the rear seats. Figures 6 & 7.

Installed**



Figure 1

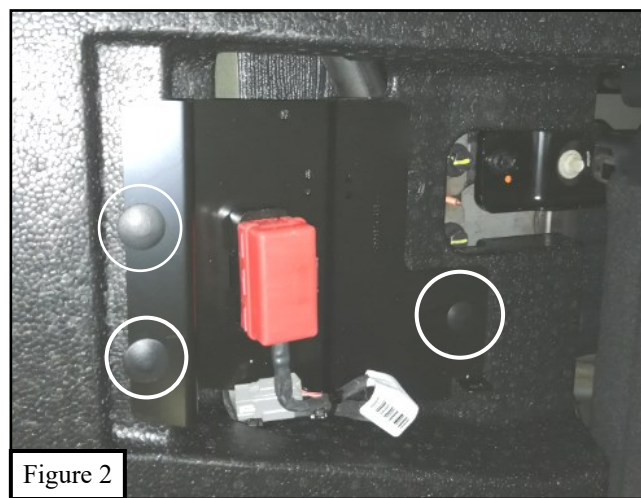

Figure 2



Figure 3



Figure 4



Figure 5

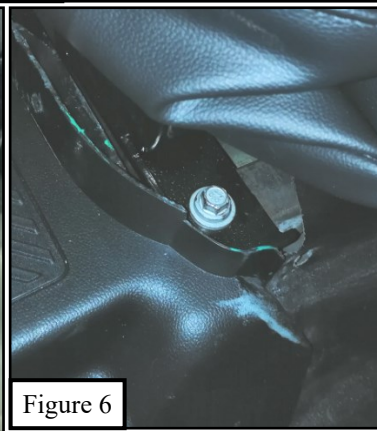

Figure 6

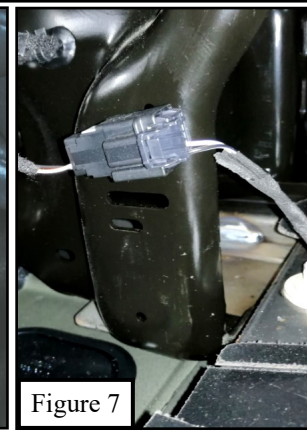
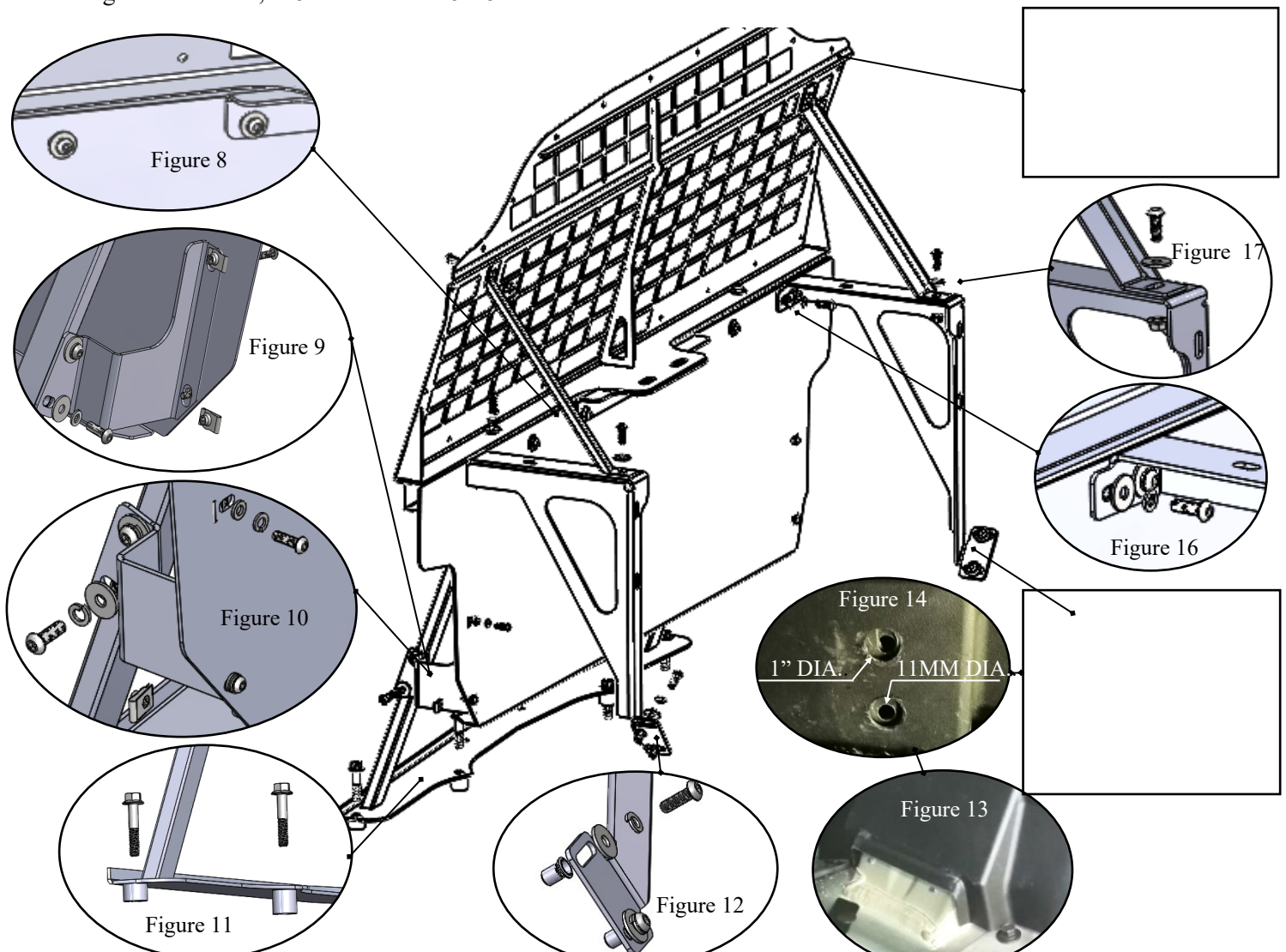

Figure 7

LAGUNA
MANUFACTURING



2. Using 4 M10 flange bolts (20) install the frame (3) at the same location where rear seat bolts were removed (Figure 11) Leave them loose for now.
3. Reinstall the foam blocks that were removed and trimmed at steps 3, 4 and 5.
4. Install inner support brackets to the frame using M8 hardware (11, 12, and 13). Figures 8 & 9. Leave them loose for now. Place M6 u-clips (19) on slots. Figure 9.
5. Install Filler panel (2) and Seat Belt Bracket (10) using M8 hardware (11, 12, and 13). Figure 8. Use M6 hardware (16, 17 & 18) to hold the filler panel into inner support bracket (8 & 9) and into the M6 U-clips (19)
6. Install support brackets (4 & 5) using M8 hardware (11, 12, and 13), to the frame and filler panel. Figure 16.
7. Use a marker to mark where two holes are going to be needed at the bottom flange with slots on the Support brackets (4 & 5) and on top of the plastic panels to tighten brackets down on both sides. Figures 13, 14, and 15. **Make sure that it is marked in top of the metal (Figure 15). 1st use 1 inch hole saw to drill the plastic panel only (Figure 14).** Then carefully drill 11mm holes in the metal. **Note:** Be sure to drill to 2 layers of metal only.
8. Install the Riv-nuts (14) using the Riv-nut install tool (21), M8 hex head bolt (22) and the M8 start washer (23) **Figure 19 in page 4.** Then use M8 hardware (11, 12, and 13) to hold the brackets down.
11. If the prisoner seat will be installed, position the seat in place without installing. Align and adjust as necessary then tighten hardware, M8 hardware to 15-18 ft-lbs, M6 hardware to 5-7 ft-lbs, and M10 hardware to 30-35 ft-lbs.
12. Install Rear guard screen using the support straps (6 & 7) and M8 hardware (11, 12 & 15) Align and adjust as necessary then tighten hardware, M8 hardware to 15-18 ft-lbs.



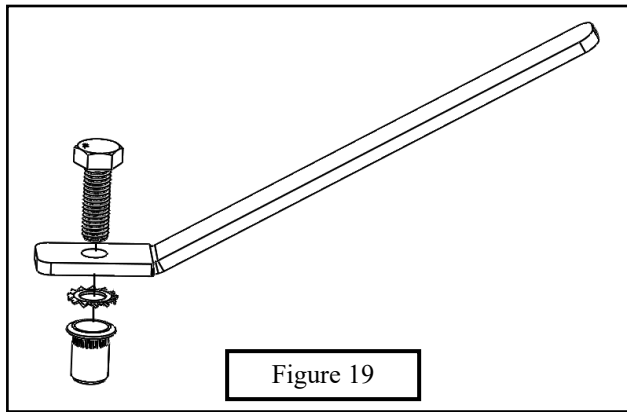

Figure 19

Installation Complete For Frame
Continue On for Seat

Images shown rear partition installed with optional Electrical Panel, Optional Poly Window overlay and Prisoner Seat with Ready Buckle.



CARE INSTRUCTIONS

- REGULAR WAXING IS RECOMMENDED. DO NOT USE ANY TYPE OF POLISH OR WAX THAT MAY CONTAIN ABRASIVES.
- STAINLESS STEEL PRODUCTS CAN BE CLEANED WITH MILD SOAP AND WATER. STAINLESS STEEL POLISH SHOULD BE USED TO POLISH SMALL SCRATCHES.
- GLOSS BLACK FINISHES SHOULD BE CLEANED WITH MILD SOAP AND WATER.

LAGUNA
MANUFACTURING





WARNING

Failure to follow these instructions could lead to death, personal injury, and / or property damage.

Failure to follow these instructions could lead to death, personal injury, and / or property damage.

FASTENERS:

All Laguna supplied fasteners must be utilized and installed in accordance with the installation instructions and apply torque to the specifications as defined. **DOUBLE CHECK ALL FASTENERS BEFORE INITIAL USE, AND PERIODICALLY IN THE FUTURE TO ENSURE PROPER FUNCTION AND SAFETY.**

DRILLING:

Most Laguna products do not require drilling for installation. If drilling is defined as required, use caution when drilling a vehicle. **FAILURE TO REVIEW AN AREA TO BE DRILLED MAY RESULT IN PERSONAL INJURY AND/OR INJURY TO OTHERS AS WELL AS VEHICLE DAMAGE.**

EYE PROTECTION:

ALWAYS WEAR SAFETY GLASSES OR GOGGLES DURING THE INSTALLATION PROCESS TO AVOID PERSONAL INJURY.

FOR CALIFORNIA RESIDENTS ONLY-PROP 65 WARNING:

Some products may contain chemicals such as DEHP, which can cause cancer, birth defects or other reproductive harm. For more info go to www.p65warnings.ca.gov



Seat and Ready Buckle Install

ITEM	QUANTITY	DESCRIPTION	
1	1	Transport Seat	
2	2	Ready Buckle Retractors	
3	2	Ready Buckle Partition Buckles	
4	2	Ready Buckle 9" in Seat Buckles	
5	2	Ready Buckle M12 40mm Retractor Mounting Top Frame Bolts	
6	2	Ready Buckle Retractor M12 Nuts	
7	2	3/8 in bolts for Ready Buckle Floor Mount	
8	2	3/8 in Nuts for Ready Buckle Floor Mount	
9	2	5/16 in washers for Ready Buckle Floor Mount	
		When installing seat you will reuse OEM Floor mount seat bolts that were removed to tighten the seat down	
		When installing side of seat 9in buckles you will reuse factory bolts	
ANTI-SEIZE LUBRICANT MUST BE USED ON ALL STAINLESS STEEL FASTENERS TO PREVENT THREAD DAMAGE AND GALLING			

LAGUNA
MANUFACTURING



CRITICAL!!!

Ford Factory belts have sensors on them. If these belts are not plugged back in their exact locations the dash will send off an alarm light that will not shut off. Each factory belt after removed from the oem seat must be plugged back in the same exact seating location where the belt came out from, you can not mix the locations up. Do one belt removal from the oem seat at a time and plug back into it's original location, failure to do so will continue to alert the dash that a sensor is unhooked.

We recommend after plugging belts back in you zip tie the belt and wire harness to floor frame, center belt wire harness may be easier to pull over top of frame and zip tie as wire is shorter to get under to.

See Image below of wire harness you will plug into



Install Side 9in buckles into original factory belt locations on each outer side of the vehicle, if you have not done so remove the factory seat belt from floor of the vehicle and push back out of the way.

You must remove the bottom floor trim panel at door entry to reach the bolt, it also may be easier to get to the factory belt bolt by removing or loosening up side trim panel



Now you can place the seat in the vehicle. Make sure buckles are pulled out on each side of the seat when placing the seat in place. You now will reuse factory oem seat bolts that were removed earlier to put in seats bottoms 4 holes, do not tighten fully yet and you may have to adjust seat a bit to line up all holes



1) Referencing back to partition install on frame, you now will install top partition and components as this must be done first so you can fasten the top of the seat. The top partition must be in to run your hardware through the partition then each seat corner hole at top lip of seat then through the frame and tighten.

2) Once partition is mounted you can now install Ready Buckle retractors.

*****Retractor Belts will not pull out until mounted level on frame, they have sensors That lock buckle up from pulling out if retractor is not 100% level*****

3) Remove top covers from retractors, place retractors on center partition frame and slide belt with anchor through partition slots and let rest on top of the seat. Install M12 bolts through each retractor hole and through the frame, tighten with provided hardware.

4) Inside vehicle take the anchor ends and carefully push through center seat slot, Now go into the rear of the vehicle and using 3/8 provided hardware mount each anchor through hole in center of the oem frame
*****See Image Below*****



Install partition buckles with provide hardware. Mounting location varies depending on brand of partition and or customer preference. Make sure buckle opening is easy to access for user to lock and unlock but not protruding too far out to avoid injuries. See example



You now can install back panel or optional electronics panel. Tighten any loose bolts and secure seat floor bolts if not done yet. Factory Belts can be tucked behind frame and or zip tied up to opening

